

QUICK-START GUIDE

As used with *Thinklogical's™ Velocitydvi-3+ and the Velocitykvm-24 Video Extension Systems*

router VX160 KVM Matrix Switch

Powered by
MRTS Technology

The **VX160 Router Critical Hardware Alarms:** (Located at the top, left rear of the unit.)

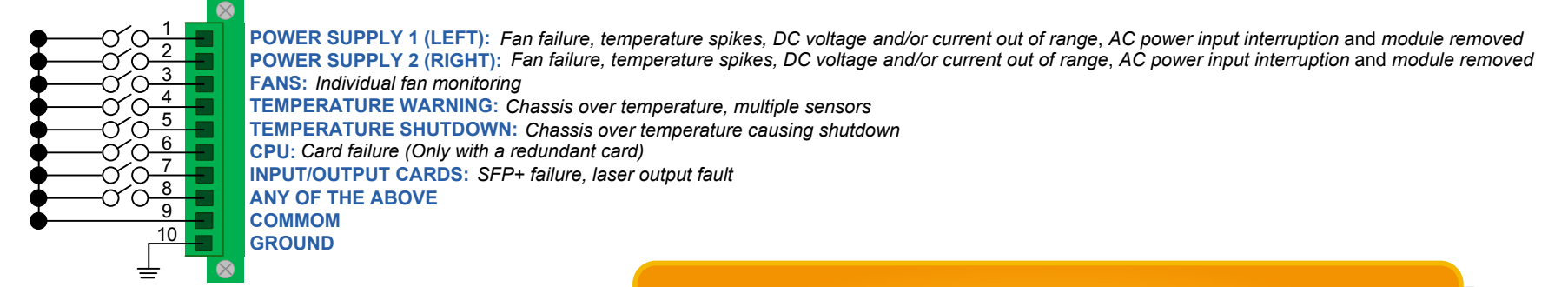

Dual Head DVI & KVM Source

STEP 5: Connect the DVI IN cables from the CPU to the **VelocityKVM Transmitter** and the DVI OUT cable(s) from the transmitter to the local monitor(s).

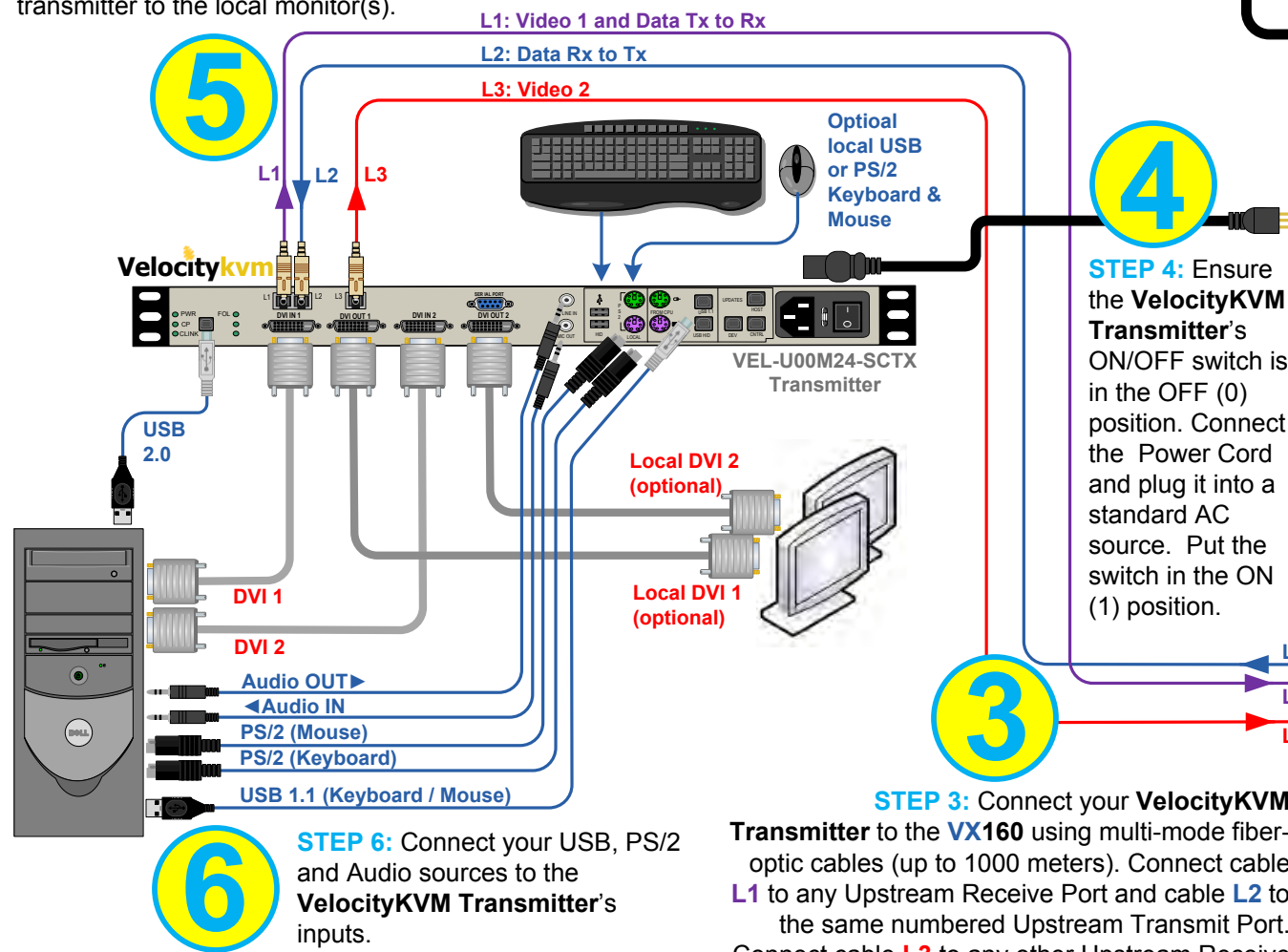

Single Head DVI Source

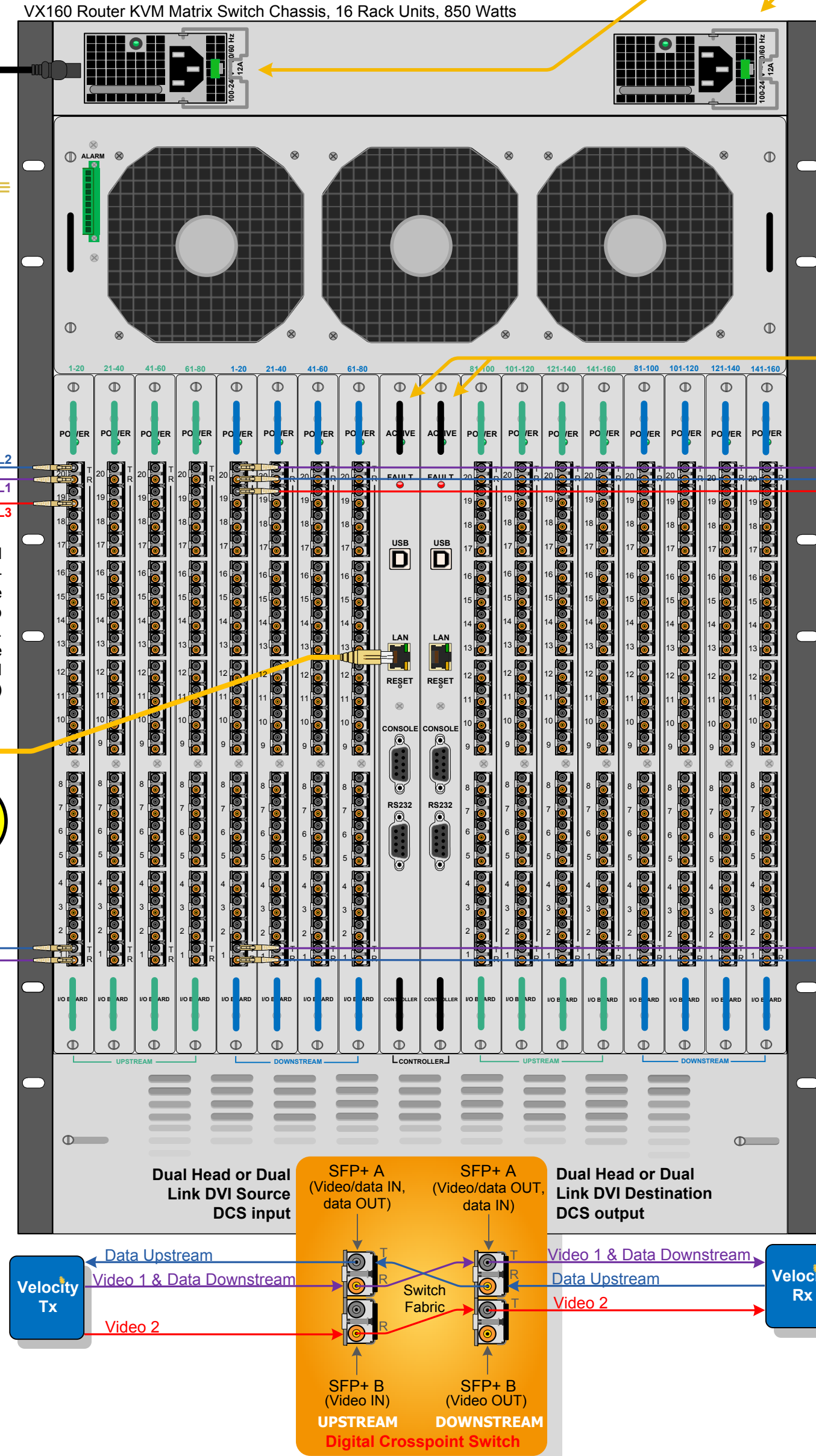
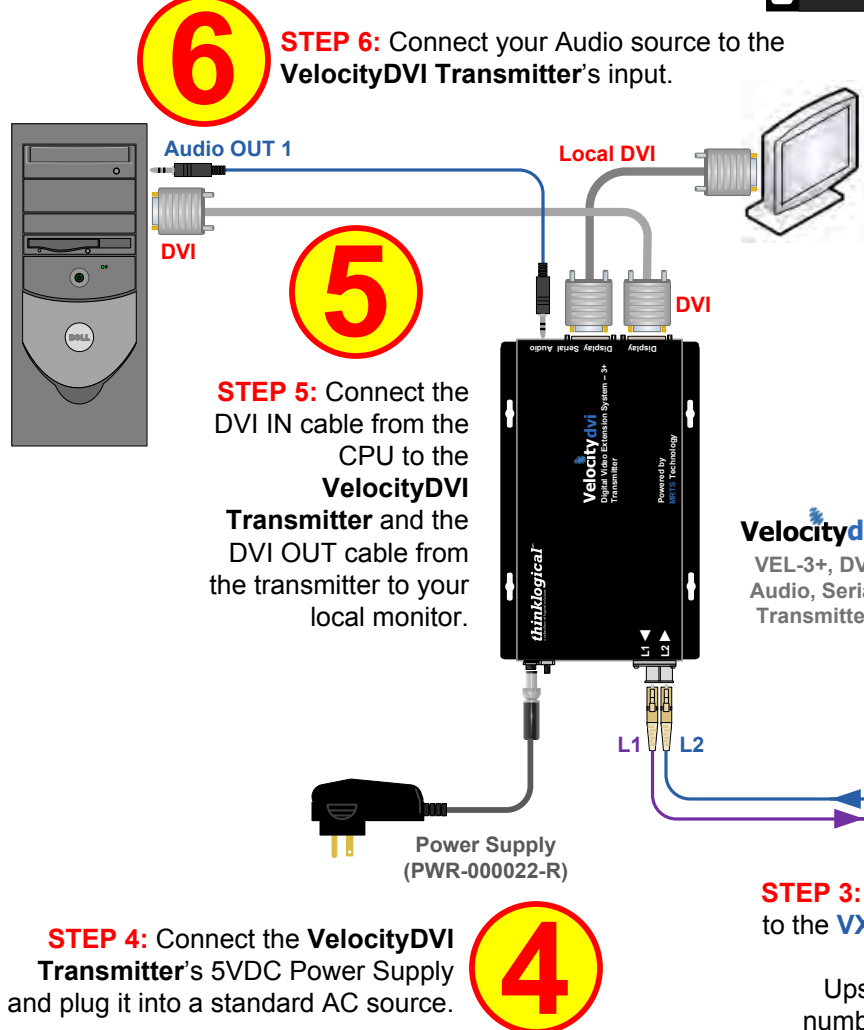

Thinklogical's™ VX160 KVM Matrix Switch features redundant Power Supplies and Fail-Over Controller Modules for uninterrupted performance, even during system reconfiguration, updates or debug. The **VX160** remains fully functional with only one Power Supply installed or with one Controller activated.

NOTE: When using a single Controller, the module on the left must be used.

Dual Head DVI & KVM Destinations

STEP 1: Connect your **VelocityKVM Receiver** to the **VX160** using multi-mode fiber-optic cables (up to 1000 meters). Connect **L1** to any Downstream Transmit Port and **L2** to the same numbered Downstream Receive Port. Connect **L3** to any other Downstream Transmit Port. (See the *Digital Crosspoint Switch* detail diagram, below left.)

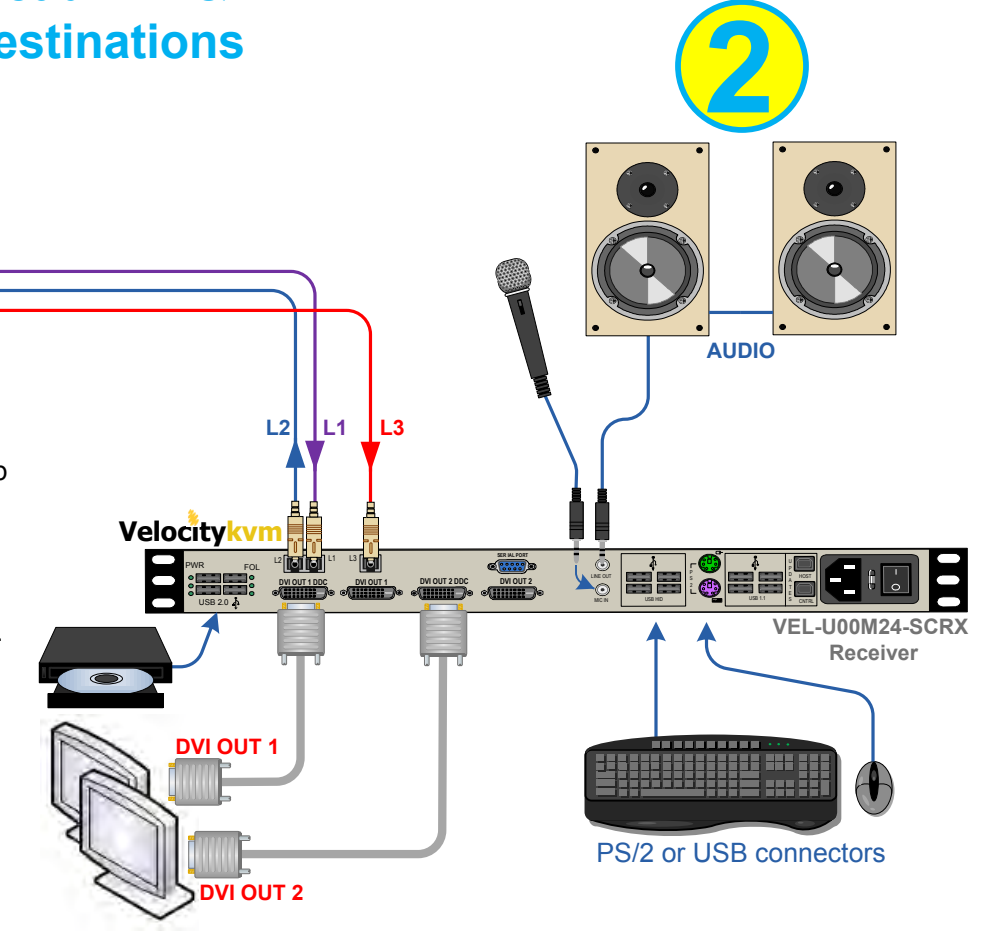

Monitor, Projector and Audio Destinations

STEP 1: Connect your **VelocityDVI Receiver** to the **VX160** using multi-mode fiber-optic cables (up to 1000 meters). Connect **L1** to any Downstream Transmit Port and **L2** to the same numbered Receive Port. (See the *Digital Crosspoint Switch* detail diagram, left.)

