

QUICK-START GUIDE

As used with *Thinklogical's*™ Velocitydvi-6AV+ and the Velocitykvm-28 Video Extension Systems

router VX160 KVM Matrix Switch

Powered by
MRTS Technology

The VX160 Router Critical Hardware Alarms: (Located at the top, left rear of the unit.)

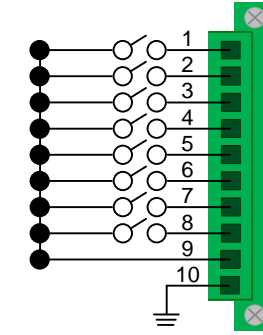

- POWER SUPPLY 1 (LEFT): Fan failure, temperature spikes, DC voltage and/or current out of range, AC power input interruption and module removed
- POWER SUPPLY 2 (RIGHT): Fan failure, temperature spikes, DC voltage and/or current out of range, AC power input interruption and module removed
- FANS: Individual fan monitoring
- TEMPERATURE WARNING: Chassis over temperature, multiple sensors
- TEMPERATURE SHUTDOWN: Chassis over temperature causing shutdown
- CPU: Card failure (Only with a redundant card)
- INPUT/OUTPUT CARDS: SFP+ failure, laser output fault
- ANY OF THE ABOVE
- COMMON
- GROUND

Dual Head DVI and KVM Source

STEP 3: Connect the DVI IN cables from the CPU to the VelocityKVM Transmitter and the DVI OUT cable(s) from the transmitter to the local monitor(s).

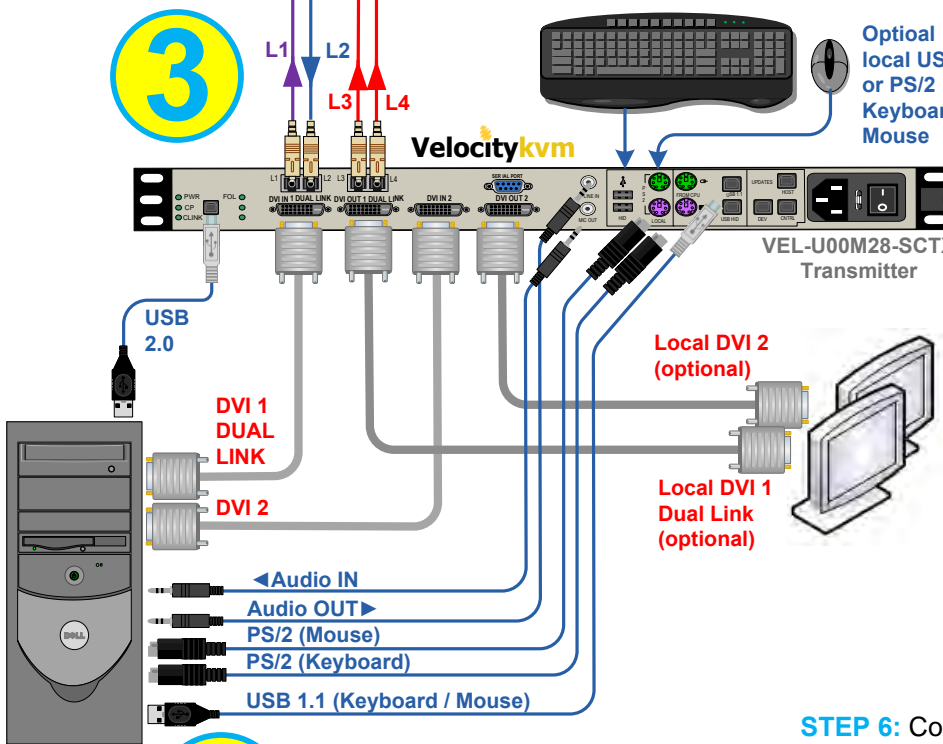

STEP 8: Connect both supplied AC Power Cords (PWR-0000056-R) to the receptacles located on the VX160's power supplies. Plug each one into a standard AC source. Verify that all system functions are operating properly.

8

5

STEP 5: Ensure the VelocityKVM Transmitter's ON/OFF switch is in the OFF (0) position. Connect the Power Cord and plug it into a standard AC source. Put the switch in the ON (1) position.

6

STEP 6: Connect your Velocity Transmitter to the VX160 using multi-mode fiber-optic cables (up to 1000 meters). Connect cable L1 to any Upstream Receive Port and cable L2 to the same numbered Upstream Transmit Port. Connect cables L3 and L4 to any other Upstream Receive Ports. (See the Digital Crosspoint Switch detail diagram, below.)

DVI Video, Serial & Audio Source

STEP 3: Connect your DVI cable from the Source CPU to the Velocitydvi-6AV+ Transmitter's DVI from CPU port. If desired, connect a local video device to the DVI to Local Display port.

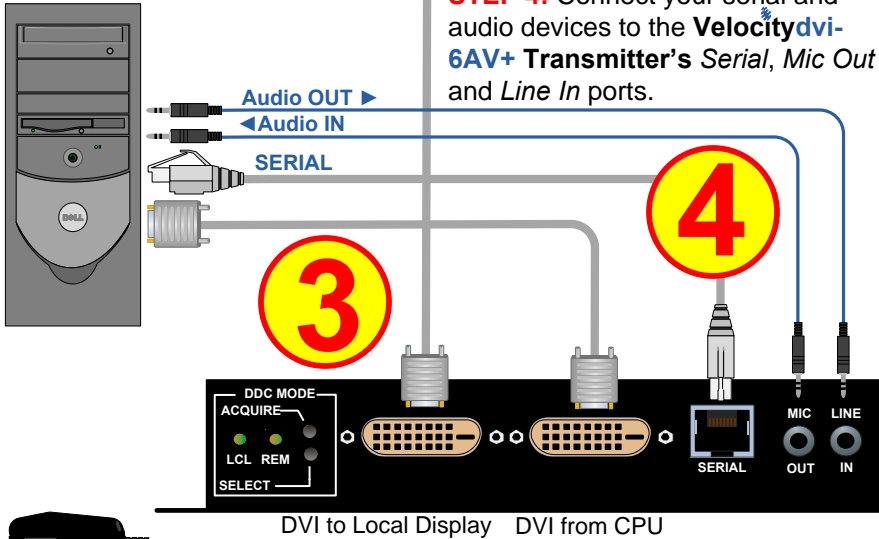

STEP 4: Connect your serial and audio devices to the Velocitydvi-6AV+ Transmitter's Serial, Mic Out and Line In ports.

4

STEP 6: Connect your Velocity Transmitter to the VX160 using multi-mode fiber-optic cables (up to 1000 meters). Connect cable L1 to any Upstream Receive Port and cable L2 to the same numbered Upstream Transmit Port. Connect cable L3 to any other Upstream Receive Port. (See the Digital Crosspoint Switch detail diagram, right.)

STEP 5: Connect the 5VDC Power Supply and plug it into a standard AC source.

5

Linux Operating System

STEP 7: Connect the Controller Card LAN Port to your Linux CPU with a CAT5 cable. (IP address: 192.168.13.15)

7

VX160 Router KVM Matrix Switch Chassis, 16 Rack Units, 850 Watts

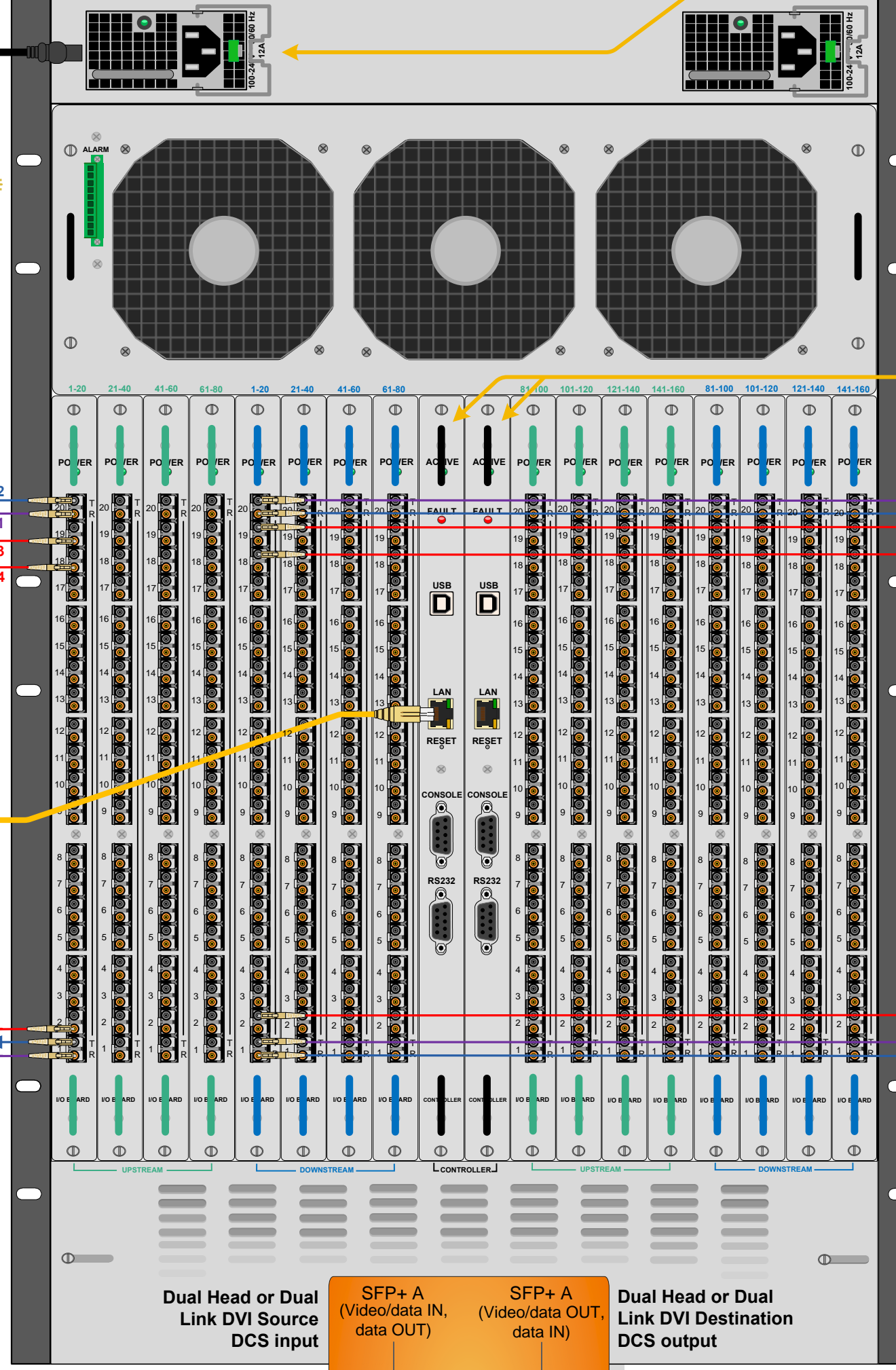

L1: Video 1 Primary and Data Tx to Rx
L2: Data Rx to Tx
L3: Video 1 Secondary

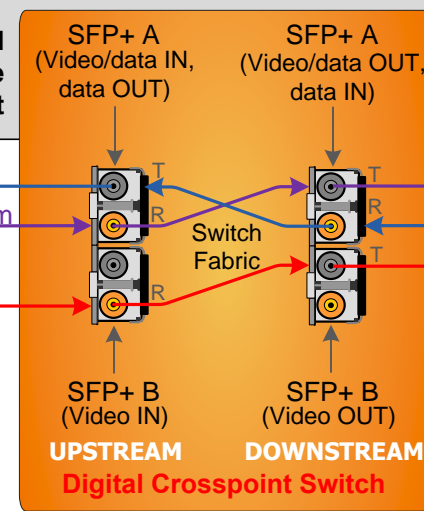

Dual Head DVI and KVM Destinations

STEP 1: Ensure that the VelocityKVM Receiver's ON/OFF switch is in the OFF (0) position. Depending on your configuration, connect your desktop devices (monitors, keyboard, mouse, etc.) to the Receiver using standard cables as shown in the example below. Turn all the devices ON. Insert the AC power cord into the Receiver and plug it into a standard AC source. Turn the unit ON.

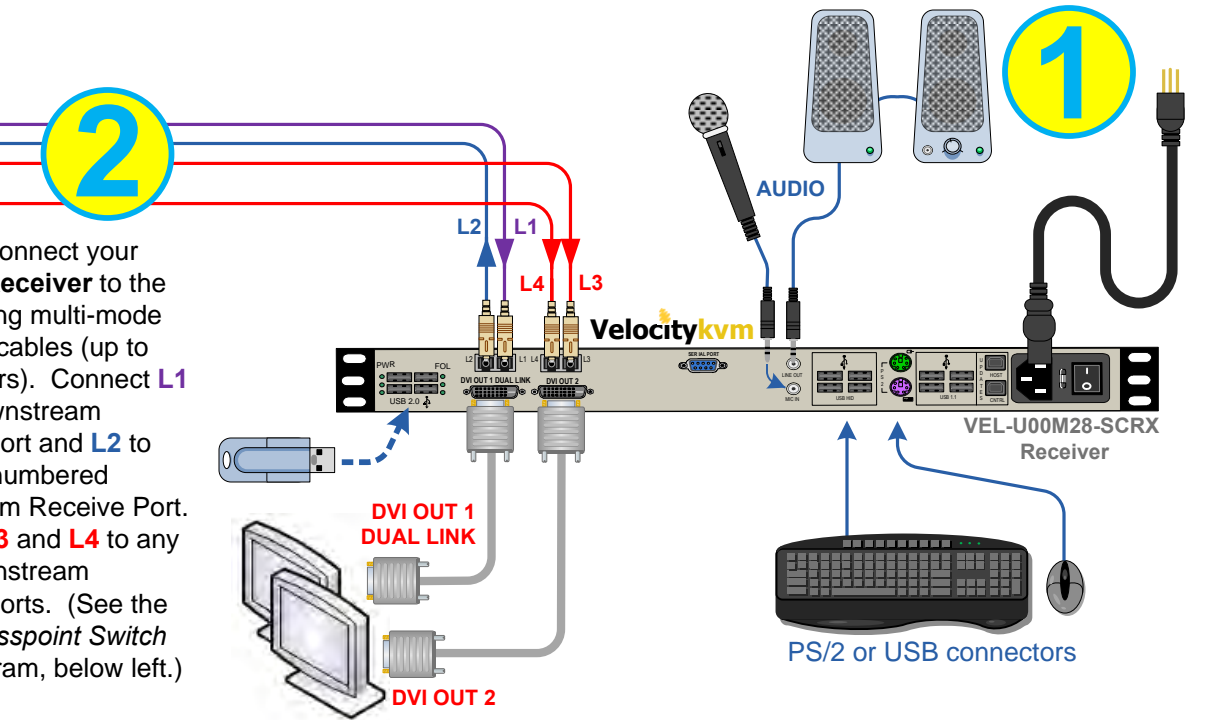

STEP 2: Connect your Velocity Receiver to the VX160 using multi-mode fiber-optic cables (up to 1000 meters). Connect L1 to any Downstream Transmit Port and L2 to the same numbered Downstream Receive Port. Connect L3 and L4 to any other Downstream Transmit Ports. (See the Digital Crosspoint Switch detail diagram, below left.)

DVI Video, Serial & Audio Destinations

STEP 1: Depending on your configuration, connect your video, serial and audio devices to the Velocitydvi-6AV+ Receiver using standard cables. Turn all the devices ON. Connect the 5VDC power supply to the Receiver and plug it into a standard AC source.

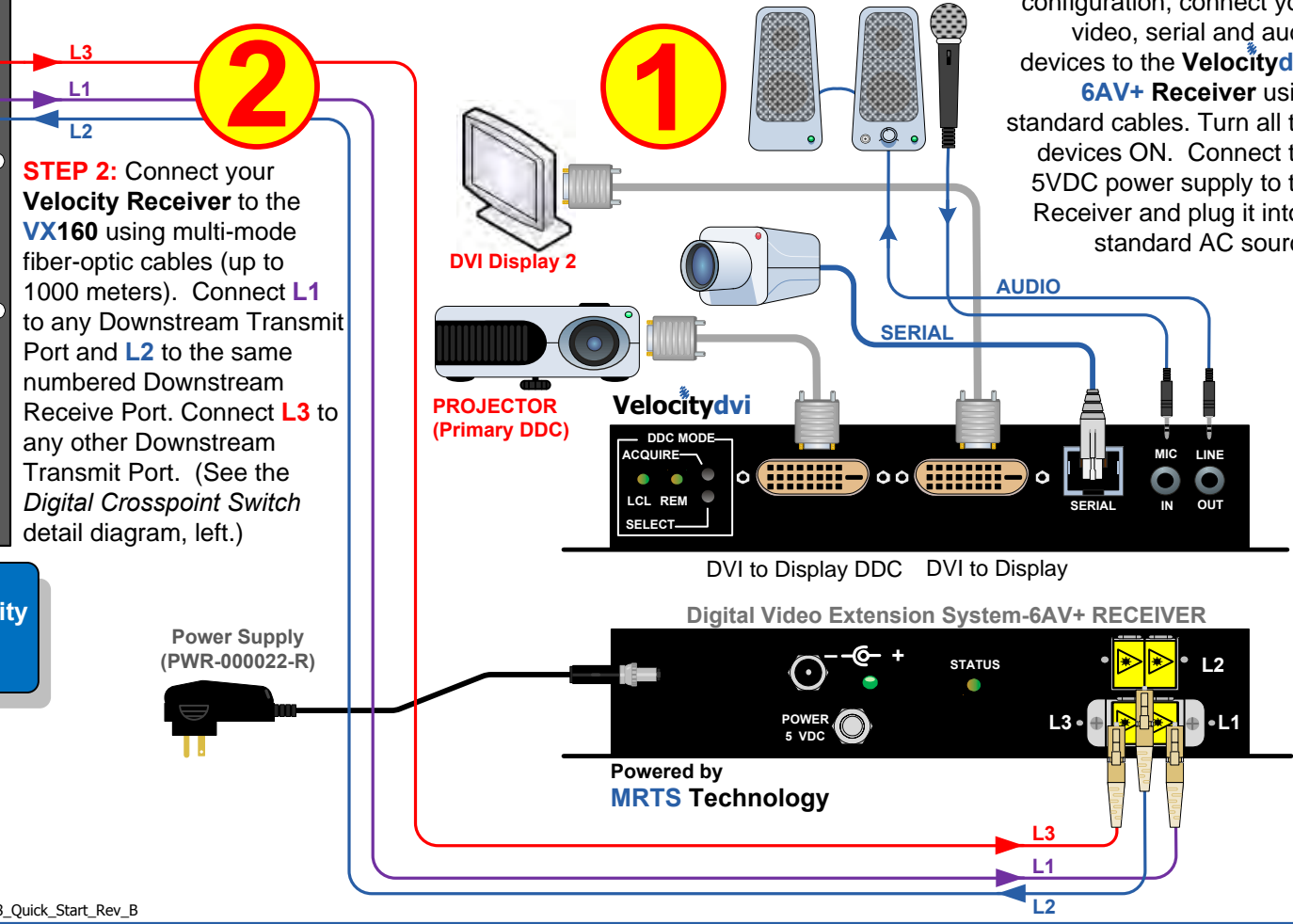

STEP 2: Connect your Velocity Receiver to the VX160 using multi-mode fiber-optic cables (up to 1000 meters). Connect L1 to any Downstream Transmit Port and L2 to the same numbered Downstream Receive Port. Connect L3 to any other Downstream Transmit Port. (See the Digital Crosspoint Switch detail diagram, left.)